

B2B Connect Update – April 2025

Key Updates

Accident Calculation Upload

B2B Connect can now automatically find part numbers from vehicle repair estimate PDFs, saving you valuable time.

Parts Validation

When uploading parts lists or vehicle repair estimates, B2B Connect checks parts using the car's VIN, finding matches or replacements automatically, or letting you pick manually.

Safety Data Sheets for Chemical Products

To comply with EU law, a link to Safety Data Sheets will be added to the checkout and order confirmation

Re-designed RMI product pages

Product pages for Tools, Repair and Maintenance information have been redesigned with improved content, layout, and mobile optimization

Multi-factor Authentication

Multi-factor authentication (MFA) via PING-ID is now mandatory for accessing XENTRY applications

Accident Calculation Upload

- Vehicle repair estimates can now be uploaded to help you order parts quickly from B2B Connect.
- Repair estimate PDFs from Audatex or DAT can be uploaded and the system automatically extracts the relevant part numbers from the document and presents them ready to be added into the shopping basket of B2B Connect.
- Simply click on the upload button on the toolbar to attach the repair estimate PDF.

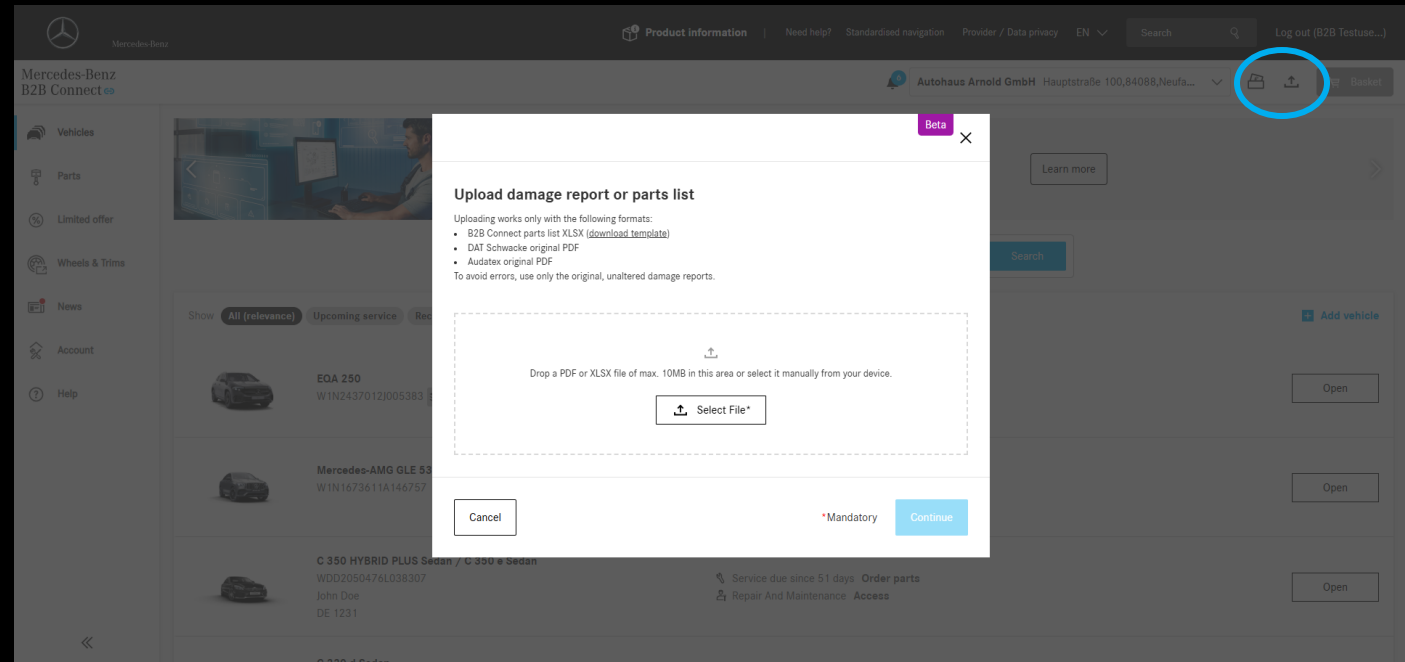

Parts Validation

- To ensure the correct parts are ordered, B2B Connect has a parts validation feature which checks uploaded part number lists against the Vehicle Identification Number (VIN).
 - **Automatic Matching:** Parts are highlighted in green if they match.
 - **Direct Replacements:** Automatically applied when available.
 - **Alternatives:** Choose from multiple options.
 - **Manual Selection:** If no match, manually search for parts.
- This feature works for both repair estimate PDF and parts lists uploads.
- Please ensure the VIN is included for accurate validation.

Please check the imported items

Valid items will only be added to your basket in the next step. Invalid items that are not replaced cannot be added.

VIN: WDD2050476L038307

| Status | Part number | Description | Quantity | Options |
|--------|-----------------|-----------------------------------------------------------|----------|---------|
| Valid | A 204 350 21 62 | REAR AXLE DIFFERENTIAL Rear axle differential | 1 | |
| Valid | A 205 350 01 41 | WHEEL CARRIER Left | 1 | |
| Valid | A 205 357 04 00 | REAR-AXLE WHEEL FLANGE Left | 1 | |
| Valid | A 004 990 63 05 | CAP SCREW Spring link to left rear axle carrier | 1 | |
| Valid | A 205 240 03 00 | ENGINE MOUNT Right | 1 | |
| Valid | A 205 240 03 45 | SCREENING PLATE Right | 1 | |

Cancel

Add items (8/9)

Safety Data Sheets for Chemical Products

- Safety Data Sheets are now available via a link during checkout process.
- Easily see if any products contain hazardous materials, as required by European Law.
- This information will always be visible in the checkout area and at the bottom of the order confirmation.

The screenshot shows the Mercedes-Benz B2B Connect checkout page. The header includes the Mercedes-Benz logo, navigation links (Product Information, Need help?, Standardised navigation, Provider / Data privacy, EN), a search bar, and a user profile (Autohaus Arnold GmbH). The main content area is titled 'Please check your summary.' and contains several sections:

- Ordering for:** A table with fields for Company (Arvato API Testbetrieb DE), Street / Nr. (Hauptstrasse 2), Postcode / Town (85778 Haimhausen), and Country (DE).
- Other:** A section with a text input field for 'Your job number (optional)' and a comment field.
- Conditions:** A section titled 'The following conditions apply: Terms of use for Mercedes-Benz B2B Connect, WebParts, After-Sales Applications and Data Content and Terms & Conditions of the involved retailer(s) and the declaration of use of the involved retailer(s). Here you will find our privacy statement.' Below this, a link 'Please note possible safety instructions for paints and operating materials.' is circled in blue.
- Sold by:** A section with the company name 'Autohaus Arnold GmbH, Hauptstrasse 100, Neufahrn 84088' and a 'Customer ID: 12345'.
- Delivery type:** A section with radio buttons for 'Collection' (selected), 'Delivery', and 'Pickup Station'.
- Order type:** A section with radio buttons for 'Stock order' (selected) and 'Immediate requirement'.
- Prices:** A note stating 'Prices may vary on selected order type.'
- VIN:** A section with a text input field.

Re-designed RMI product pages

- The Repair and Maintenance Information product pages have been fully redesigned.
- Content is now more easily accessible through an improved layout.
- Pages are now mobile-optimised, making it easier to view the information on more devices

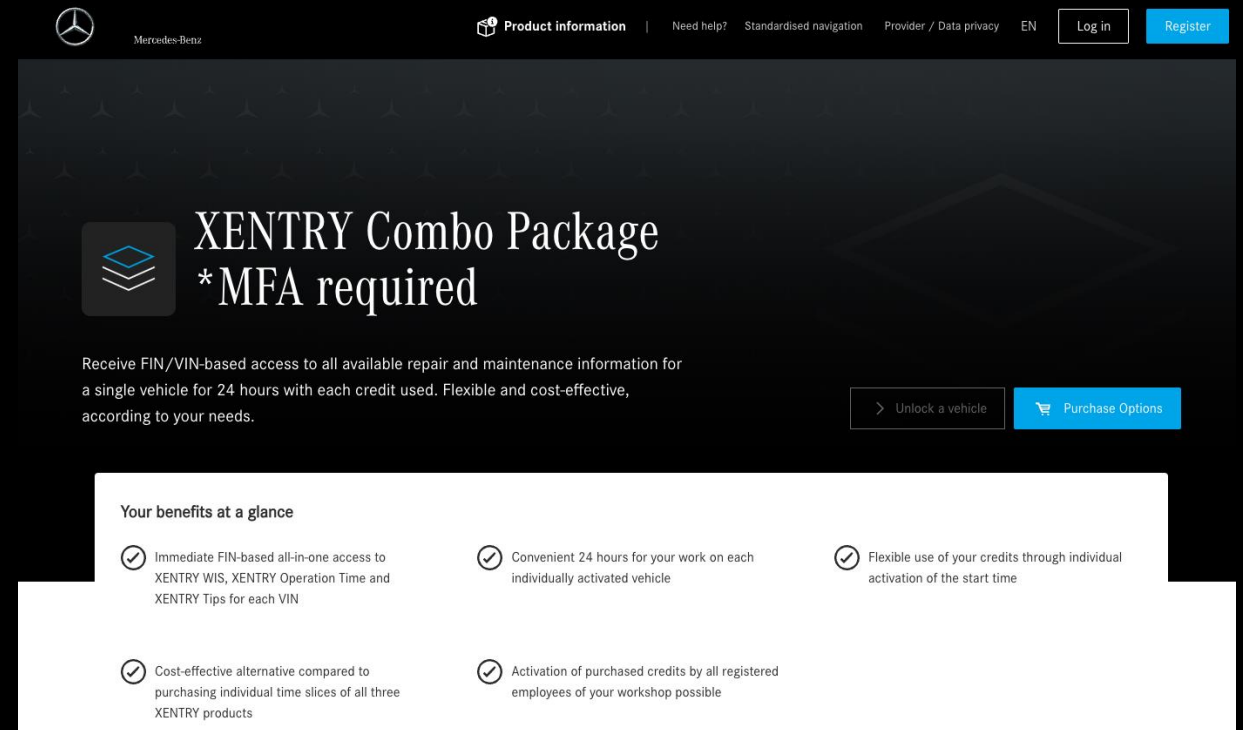

Multi-factor Authentication

- Multi-factor Authentication is now required when using our XENTRY applications (e.g. XENTRY WIS, XENTRY Tips, XENTRY Parts Information)
- Enhanced security with every access, protecting your data and ours against unauthorised access.
- To access a XENTRY application, you will need:
 - Username and password
 - Authentication app (smartphone or Windows desktop) or USB security key
 - Further information to set up MFA can be found in our MFA Guide.

